



COUNTRYMAN ASSOCIATES INC

## E6 FLEX DIRECTIONAL EARSET MICROPHONE



Supplied with cable, carrying case, black and white cable clips, wind screen, cardioid and hypercardioid caps.

The E6 Flex Directional Earset combines the best of the classic E6 directional earset with the best of the directional E6i. The slim, springy ear section grips securely like an E6 classic, while the flexible front boom takes abuse like the E6i and allows precise placement and easy reshaping. The ultra-miniature directional element delivers exceptional sound quality and rejects surrounding noise or feedback from nearby stage monitors and speakers. As part of the Countryman E6 Directional line, the E6 Flex Directional features swapable reinforced cables, versatile skin tone options, changable caps for cardioid or hypercardioid patterns, and rugged construction. It weighs less than one-tenth of an ounce and virtually disappears against the skin, so performers forget they're even wearing a mic.

### Fit and Flexibility

The fit of the classic E6 meets the flexibility of the E6i. The front boom is like an E6i, the ear section is like the classic E6: the result is the best fitting, easiest to use earset available.

### Lightest and Most Concealable

Countryman Earsets are the smallest, lightest, and least visible head-worn microphones. The E6 Flex comes in four skin tones to disappear against the face.

### Adjustable Pattern

Custom protective caps let you switch between cardioid and hypercardioid patterns in seconds.

### Exceptional Sound Quality

Frequency response is better than 30 Hz to 15 kHz with smooth off-axis response and >100 dB dynamic range. The boom positions the mic near the mouth for the clearest, most consistent sound possible.

### Rugged and Reliable

The E6 Flex is highly resistant to makeup, sweat, and moisture when used with the supplied protective caps. The skin-colored, stainless steel boom can be bent and re-bent many times to fit different performers. The front boom of the E6 Flex is slightly firmer than our E6i, so it's easily shaped right on the performer's face and smooths out for a professional look.

### Most Versatile

The E6 Flex comes in three sensitivities for different speaking or singing styles, with up to 145 dB SPL capability.

### Snap-On Cables

With other microphones a worn cable requires purchasing a completely new mic. An E6 replacement cable attaches in seconds. Quick-connect miniature 1 mm or 2 mm super-rugged cables are available in four colors for almost any wireless transmitter or phantom mic input providing 3 - 48V.

**Frequency Response** : 30 Hz to 15 kHz  
**Operating Current** : 500  $\mu$ A  
**Operating Voltage** : 1 to 2 Volts  
**Power Supply Voltage** :  
 +3V with 2.7 kOhm Load  
 +5V with 6.8 kOhm Load  
 +9V with 15 kOhm Load  
**Weight** : .07 oz (2 grams)

The E6 Flex Directional Earset is available in three sensitivities:

**Model E6XDW5** for general speaking

**Sensitivity**: 6.0 mV/Pascal  
**Equivalent Acoustic Noise**: 24 dBA SPL  
**Overload Sound Level**: 125 dB SPL

**Model E6XDW6** for loud speaking and vocals

**Sensitivity**: 1.9 mV/Pascal  
**Equivalent Acoustic Noise**: 29 dBA SPL  
**Overload Sound Level**: 135 dB SPL

**Model E6XDW7** for powerful vocals

**Sensitivity**: 0.60 mV/Pascal  
**Equivalent Acoustic Noise**: 39 dBA SPL  
**Overload Sound Level**: 145 dB SPL

### Frequency Response

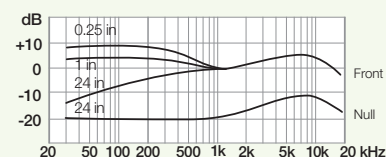

### 1 kHz Polar Response

cardioid cap

hypercardioid cap

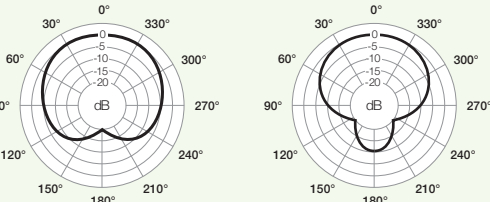

# E6 Flex Directional: Frequently Asked Questions

## How do I wear an E6 microphone?

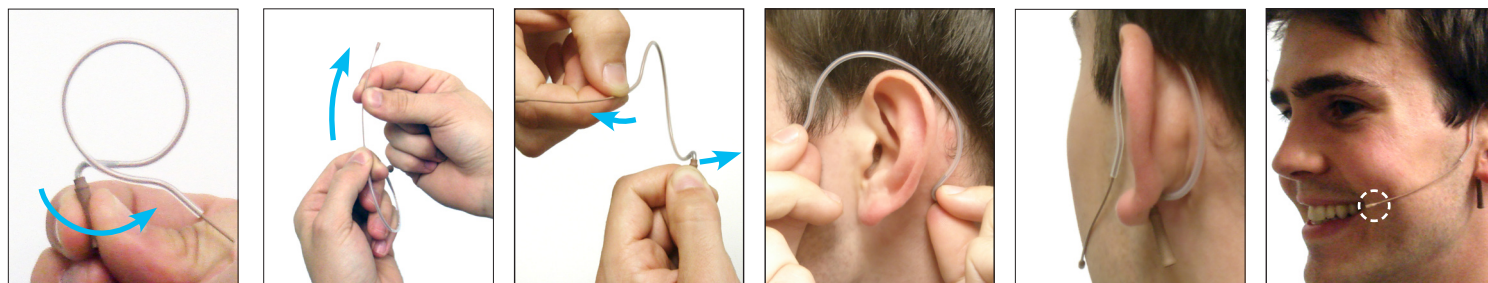

1. Tighten the ear loop.
2. Slide your fingers to curve the boom.
3. Spring the connector away from the boom.
4. Put the loop over the ear with the base behind the earlobe. The boom can touch the cheek.
5. Put the mic near the corner of the mouth.

## How do I choose the right E6 for my application?

- The **E6 Flex** offers a versatile blend of the E6 and the E6i. With a springy, thin earpiece and a flexible boom, the E6 Flex is faster to fit a new face than any other earset microphone available—all without compromising true invisibility and world class sound. The E6 Flex is marked with an orange band.
- The **classic E6** is a good choice when one person will wear the microphone. Because the boom is stiffer, once it is adjusted to fit the user's face, it can be stored away, unpacked, and quickly worn with a minimum of fuss.
- The **E6i** is soft and highly-flexible with a larger silicone rubber ear piece. When multiple users share a mic, the E6i is a great choice. The soft boom is fantastically durable and the extreme flexibility makes changing users a breeze.

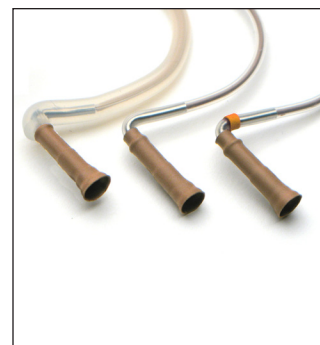

## When should I choose a directional earset rather than an omni?

The omni earset rejects unwanted sound and feedback better than a lavalier almost any way you wear it, so it's very user-friendly for new and experienced users alike. For situations where there are loud monitors, extreme feedback or environmental noise, choose the Countryman Directional Earset (marked with a green band).



## How do I choose the right color for my skin tone?

In most cases the boom of the E6 will be against the performer's skin. Tan is the most popular color choice, because it works perfectly for average Caucasian skin tones as well as olive complexions. Light beige works well in theatrical applications due to its slightly pink undertone, which is also appropriate for extremely fair skin. Cocoa is the ideal choice for African American skin tones ranging from very light to chocolate, and black is appropriate for extremely dark skin or for situations where you want the mic to be visible. When in doubt, a darker option tends to blend better and draws less attention.

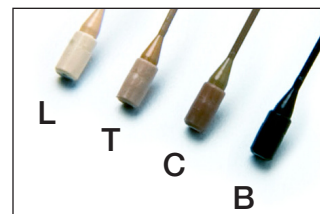

## Which E6 sensitivity should I choose?

Making a microphone more sensitive to catch soft sounds means it will overload sooner for loud sounds. Because sound pressure levels vary between individuals and applications, we provide three sensitivities for the E6 Flex:

- The highest gain (**W5**, no colored band) is for general speaking, such as presentations or sermons
- The medium gain (**W6**, blue band) is for vocals and loud speaking, such as in theater
- The most powerful vocals require the least gain mic (**W7**, purple band) with the highest overload level



## Which cap should I use?

The earset should always be used with a protective cap in place to keep sweat, makeup, and other foreign material out of the microphone. The directional caps modify your earset's pickup pattern:

- Hypercardioid (H) mode provides the best isolation from all directions, with a null facing toward the floor where "wedge" monitors are often placed. We recommend this mode for most applications.
- Cardioid (C) mode is slightly less directional, with a null toward the back. It's most useful when there is a monitor speaker over the shoulder or behind the performer.

