

Please check all appropriate selections and attach room schedule with verified dimensions.

Fabric Series: \_\_\_\_\_

Color Name / Number: \_\_\_\_\_

Openness Factor: \_\_\_\_\_

Please see Draper's [Fabric Options](#) for fabric colors and specifications.

#### Select Number of Shades per Unit

- ☐ Single Roller (Standard)
- ☐ Dual Roller (Supplemental Fabric & Hardware Sheet Required)

**Please Note:** If you are specifying a Dual Roller FlexShade, please complete the options BELOW and attach the [Motorized Dual Roller Fabric and Hardware Planning Sheet](#).

#### Select Fabric Orientation

- ☐ Regular Roll (from back of roller)
- ☐ Reverse Roll (from front of roller)

#### Select Single Roller Hardware

- ☐ Universal Brackets (Ceiling / Wall / Inside / Outside)
- ☐ Endcaps Only
- ☐ Endcaps with Fascia

##### Headbox

- ☐ Ceiling / Wall (Surface Headbox)
- ☐ Pocket Style
- ☐ Type "D" Pocket with Tile Lip (White only)
- ☐ Custom Headbox

##### Wall Clip

- ☐ With Ceiling Tile Lip
- ☐ Without Ceiling Tile Lip

##### Closure Panel for Type "D" Pocket or Wall Clip

- ☐ 1 1/2"
- ☐ 3" (recommended)
- ☐ 5" (For Wall Clip and Custom Headbox Only)

##### "L", "U" or "H" Channels for Light Gap Reduction

- ☐ Aluminum 'L' Angle
- ☐ Vinyl 'L' Angle
- ☐ Aluminum 'U' Channel
- ☐ Channel Liners
- ☐ Aluminum 'H' Channel

#### Select Hardware Finish (does not apply to Type "D" Headbox)

- ☐ Clear Anodized (standard)
- ☐ Ivory
- ☐ Black
- ☐ Bronze
- ☐ White
- ☐ Custom (Contact Draper)

#### Select Slat Style

- ☐ Closed Pocket (1" Elliptical - standard)
- ☐ Open Pocket (1" Elliptical)
- ☐ Small Flat Exposed Hem Bar
- ☐ Large Flat Exposed Hem Bar
- ☐ Round Exposed Hem Bar
- ☐ 13/16" Tube
- ☐ 1" Steel Oval Slat
- ☐ 5/8" Tube
- ☐ Guide Cable Hem Bar
- ☐ None

#### Select Motor Location

As seen from INSIDE the room facing the window. Also indicate on room schedule.

- ☐ Right Side (standard)
- ☐ Left Side

## Specifications

### EQUIPMENT

**BATTERY OPERATOR:** Drive unit inside roller, instantly reversible, lifetime lubricated. Right hand motor location standard. Left hand motor location also available. Limit switches adjustable using wall switch or remote control. Operates on power provided by internal Lithium Ion battery. Rechargeable by 12V power adapter or Solar Recharge Panel. Can be retrofitted to Draper manual shades.

### HARDWARE

**ROLLERS:** Extruded aluminum. Roller assembly easily removable.  
 1 1/2" dia. x .065" wall  
 2" dia. x .080" wall  
 2 1/2" dia. x .024" wall

**MOUNTING BRACKETS:** 1018 plated steel stamping. Sizes 2 3/8" and 3". Styles for mounting to wall, ceiling, or jamb. Brackets do not require additional adapters.

**ROLLER IDLER ASSEMBLY:** Fiberglass reinforced polyester thermopolymer (PBT), with spring-loaded pin to interlock with mounting bracket.

**SLAT:** Aluminum, min. 1/8" x 1", encased in heat sealed hem.

**ENDCAPS:** 1018 steel stamping. 2 sizes: 3 1/4" x 3 3/4" and 4 1/2" x 4 1/2". Complete with adapter roller bracket. Installs to face, ceiling, or jamb. Accepts box covers and fabric guide.

**ENDCAP COVERS:** Plastic covers snap onto endcaps. Available in ivory, bronze, black or white to match fascia.

**FASCIA:** L-shaped cover of extruded aluminum, .060 wall. Assembly snaps onto endcaps without exposed fasteners. Clear anodized (standard) finish or black, white, ivory or bronze powder coat finish.

**HEADBOX:** Standard consists of fascia, L-shaped back/top cover. Assembly snaps onto endcaps. Optional, for pocket installation, includes a U-shaped back/top/front cover with removable bottom closure panel. Small size: 3 7/8" x 3 15/16". Large size: 4 11/16" x 4 1 1/16". Some exposed fasteners required. Clear anodized (standard) finish or black, white, ivory or bronze powder coat finish.

**TYPE D POCKET:** Type D Shade Pocket, to be fabricated of metal for perimeter installation. Accepts FlexShades installed with ceiling brackets. Finished in white paint. 5" x 5 3/8" x .125" with 7/8" tile support lip and removable bottom closure.

#### PATENT INFORMATION:

available at [www.draperinc.com/legal/patents](http://www.draperinc.com/legal/patents)

#### DOWNLOADABLE 3-PART SPECIFICATIONS:

available at [www.draperinc.com](http://www.draperinc.com).

**Please note:** Dimensions of rollers, operators and hardware at manufacturer's discretion.

### Available Sizes

Please Note: Fabric weight and thickness determine maximum size available.

WIDTH:	2'	3'	4'	5'	6'	7'	8'	9'	10'	11'	12'
HEIGHT											
2'											
3'											
4'											
5'											
6'											
7'											
8'											
9'											
10'											
11'											
12'											

\* Sizes requiring large endcaps/brackets will vary according to fabric.



Draper, Inc. | 411 S. Pearl St. Spiceland, IN 47385  
 draperinc.com | 765.987.7999 | 800.238.7999

© 2019 All Rights Reserved | FORM: FS\_ReCharge\_Sub19

PROJECT: \_\_\_\_\_

ARCHITECT: \_\_\_\_\_

CONTRACTOR: \_\_\_\_\_

SUPPLIER: \_\_\_\_\_

DATE: \_\_\_\_\_ REVISED: \_\_\_\_\_

## Hardware Selections

**Please Note:** Brackets and endcaps have the only attachment points for mounting a FlexShade ReCharge. Optional fascia and headbox have a thickness of  $\frac{1}{16}$ ".

### Small FlexShade ReCharge Bracket

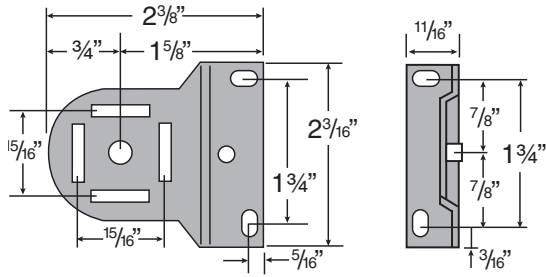

### Large FlexShade ReCharge Bracket

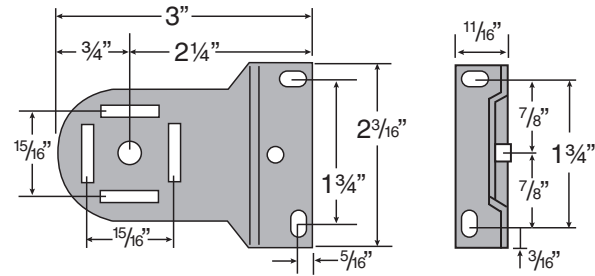

### Small FlexShade ReCharge Endcap

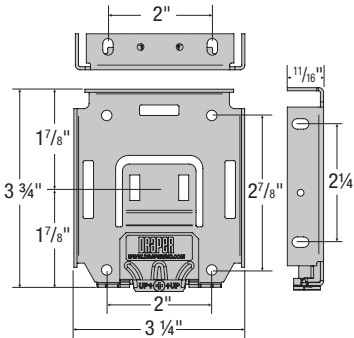

### Large FlexShade ReCharge Endcap

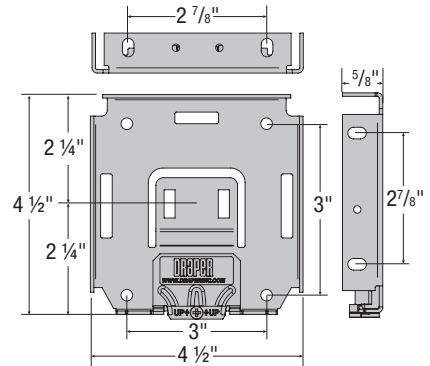

## Hardware Selections

**Please Note:** Brackets and endcaps have the attachment points for mounting a Motorized FlexShade. Optional fascia and headbox have a thickness of  $\frac{1}{16}$ " (1.5mm).

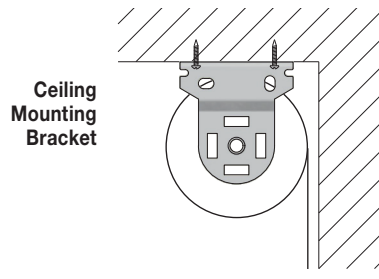
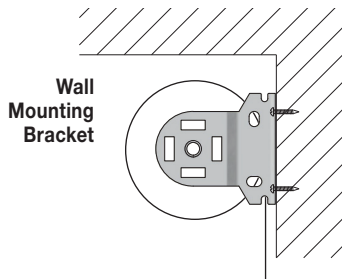

## Headbox Installation Options

### Surface Headbox

#### Consists of:

- Fascia
- Back/Top Cover
- Ceiling/Wall Endcaps

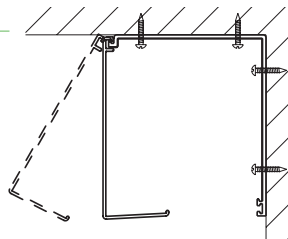

### Pocket Style Headbox

#### Consists of:

- Extruded pocket
- Bottom closure panel
- Ceiling/Wall Endcaps

SMALL:  $3\frac{15}{16}$ " x  $3\frac{7}{16}$ " (100x87mm)  
LARGE:  $4\frac{11}{16}$ " x  $4\frac{11}{16}$ " (119x119mm)

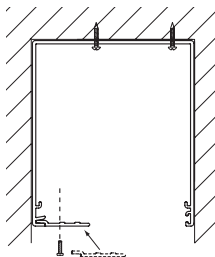

### Type D Pocket

#### Consists of:

- Fabricated steel pocket.
- A lip supports lay-in ceiling
- Pre-welded corners and ends available.
- Ends with or without tile support lip.

### Typical pre-welded corner section (not to scale)

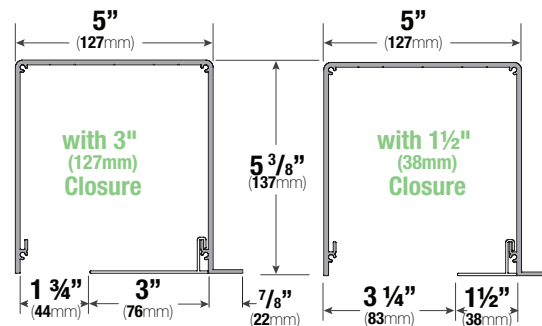
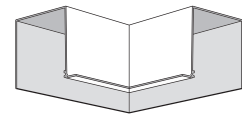

## Closure & Wall Clip Options

### Closure Options

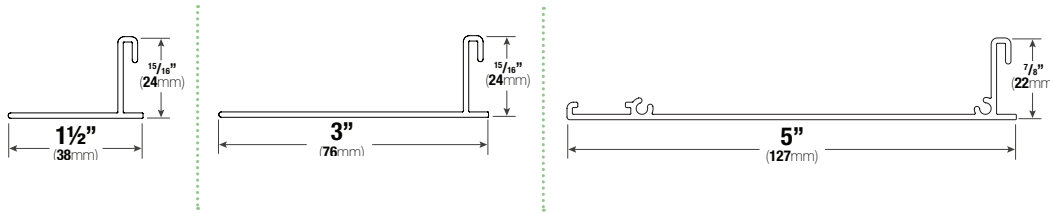

### Wall Clip Options

#### With Tile Lip

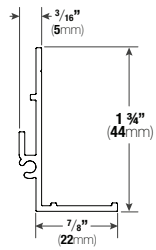

#### Without Tile Lip

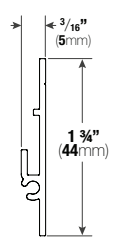

### Endcap Covers

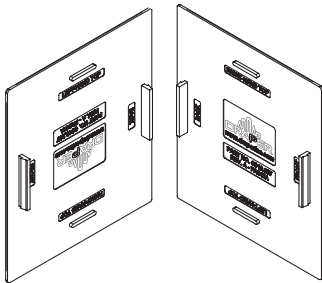

### "U" Channel

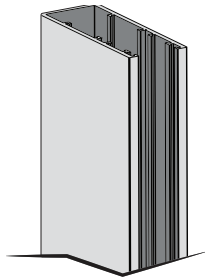

### "L" Angle

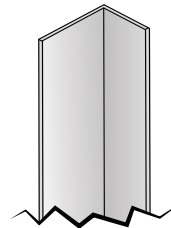

### "H" Channel

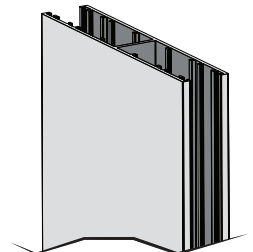

## FlexShade ReCharge Dimensions

(Fascia Overall Width includes plastic endcap covers) (Pair adds 1/8" to Overall Width)

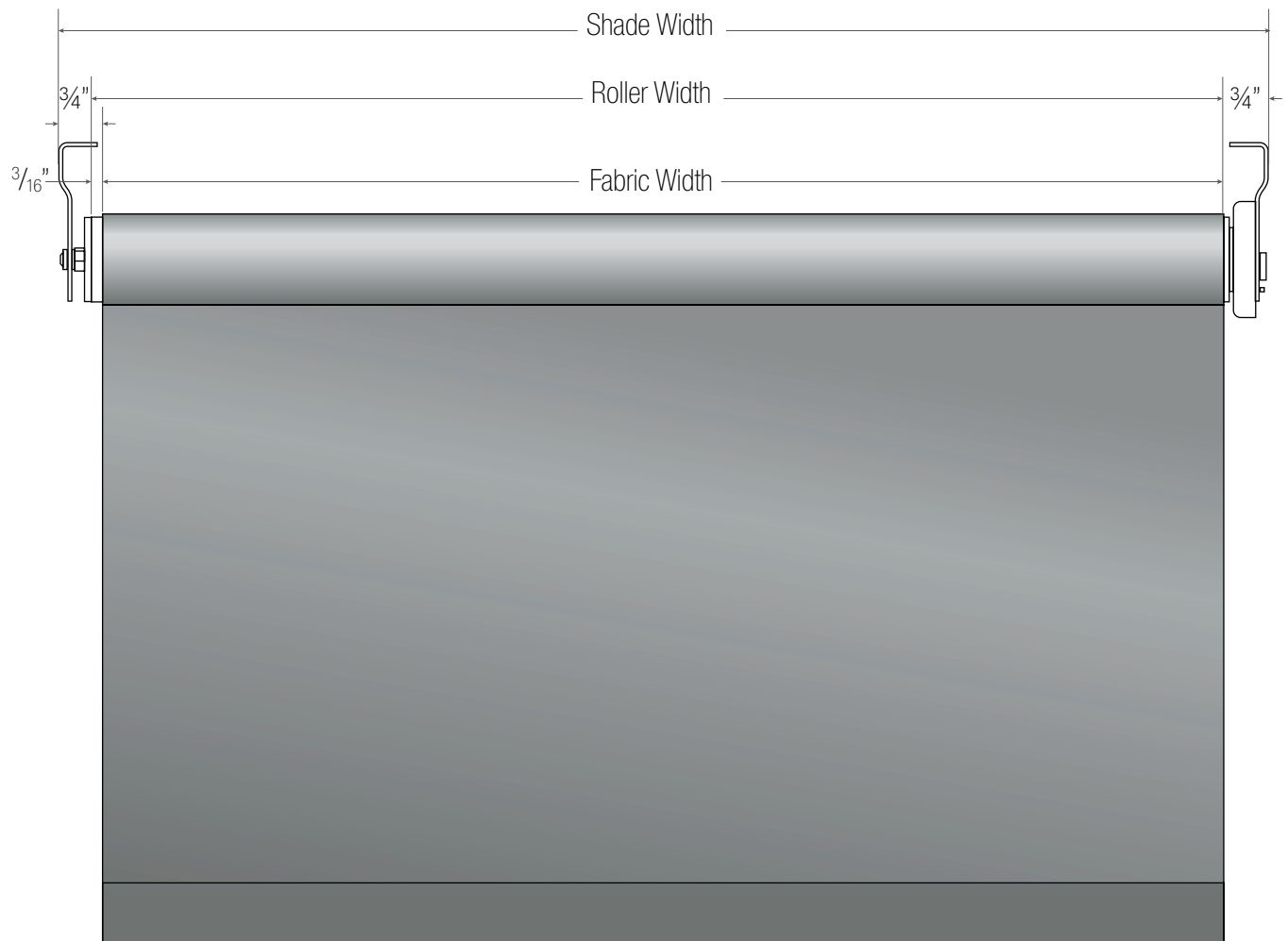

## Components

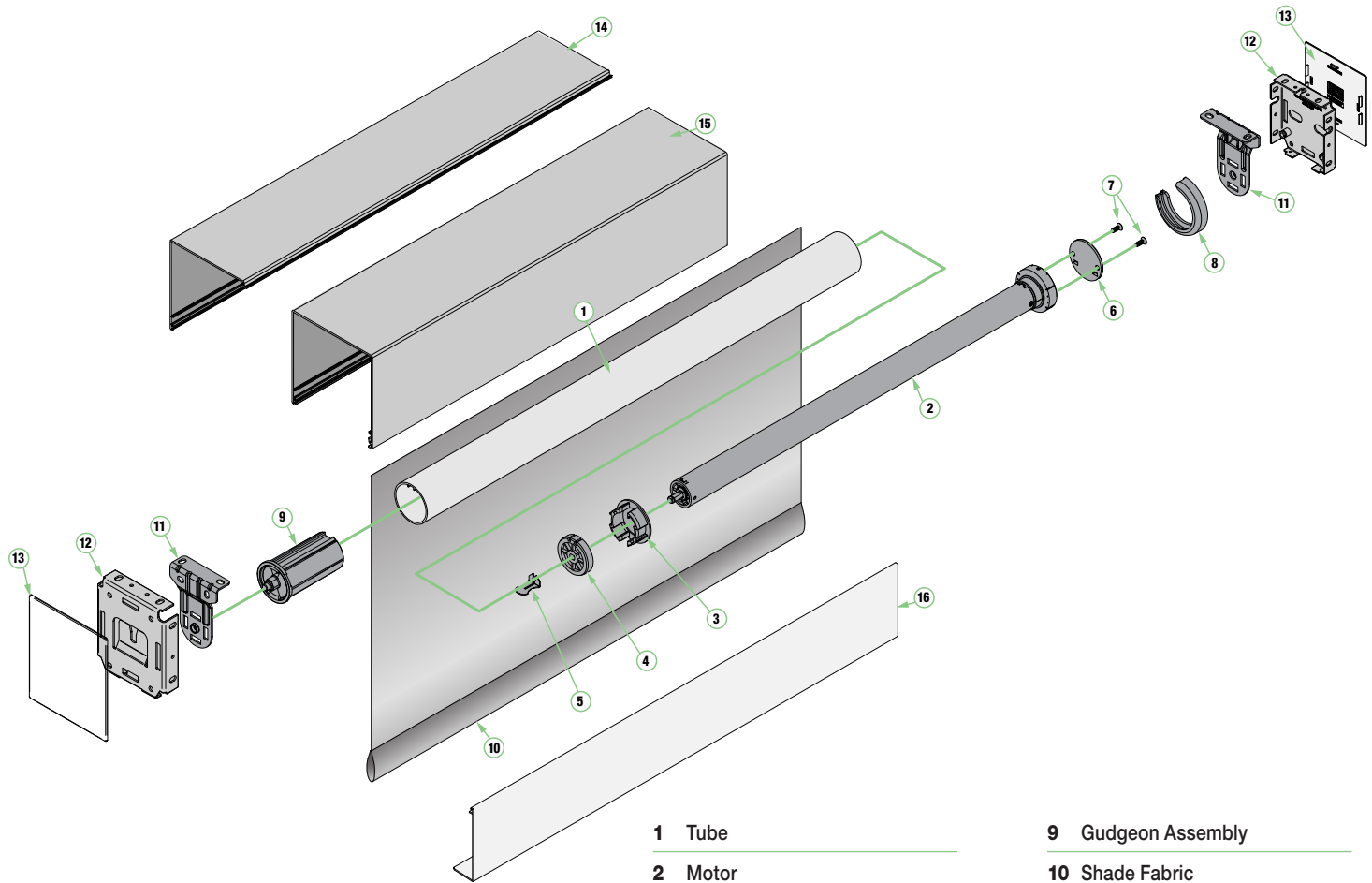

1 Tube

2 Motor

3 Motor Adaptor

4 Drive Adaptor

5 Motor Clip

6 Motor Plate

7 Adaptor Screws

8 Motor Cap

9 Gudgeon Assembly

10 Shade Fabric

11 Universal Mounting Brackets

12 Endcap

13 Endcap Cover

14 Top/Back Cover

15 Pocket Headbox

16 Fascia