

FlexShade® Zip XL

Very large exterior shading system prevents heat from entering a building.

SUBMITTAL TECHNICAL INFO

Please check all appropriate selections and attach room schedule with verified dimensions.

Fabric Series: _____

Color Name / Number: _____

Openness Factor: _____

Please see Draper's [Shade Fabric Reference Guide](#) for fabric colors and specifications.

Select Operator and Controls:

Select Motor Location:

- ☐ Right (Standard)
☐ Left

Select 120V RTS Operator:

- ☐ Altus RTS (Standard)
☐ Maestria Object Detection RTS

Select RTS Control Options:

- ☐ Altus RF
☐ Telis 1 Transmitter (1-Channel)
☐ Telis 5 Transmitter (4-Channel)
☐ Dry Contact Interface
☐ RTS Sun Sensor
☐ Wireless Wall Switch
☐ Decora RTS 1-Channel (Circle one: White / Ivory)
☐ Decora RTS 4-Channel (Circle one: White / Ivory)
☐ Telis 1 Chronis Timer (1-Channel)
☐ URTSi II Universal RTS Interface RS-232 (16-channel)

Select 120V AC Operator:

- ☐ Altus 120V Motor

Select 120V AC Control Options:

- ☐ 120V Wall Switch for Single Shade Control
☐ Low Voltage and/or Multiple Shade Control*

Hardware Selections

Select Mounting Location:

- ☐ Wall ☐ Ceiling

Select Headbox Style

- ☐ Curved ☐ Angled

Select Channel Liners:

- ☐ Headbox ☐ Fascia ☐ Side Channel ☐ Hem Bar
☐ Rear ☐ Bottom

Channel Adaptor:

- ☐ None ☐ 1½" Tube ☐ Angle

Side Channel Liners:

- ☐ Yes ☐ No

Select Hardware Finish:

- ☐ Black ☐ Bronze ☐ Ivory ☐ White ☐ Sand ☐ Silver

Select Zipper Color:

- ☐ Black (Standard)
☐ Grey

Select Cable Exit Location:

- ☐ None (Standard)
☐ Top
☐ Side
☐ Back

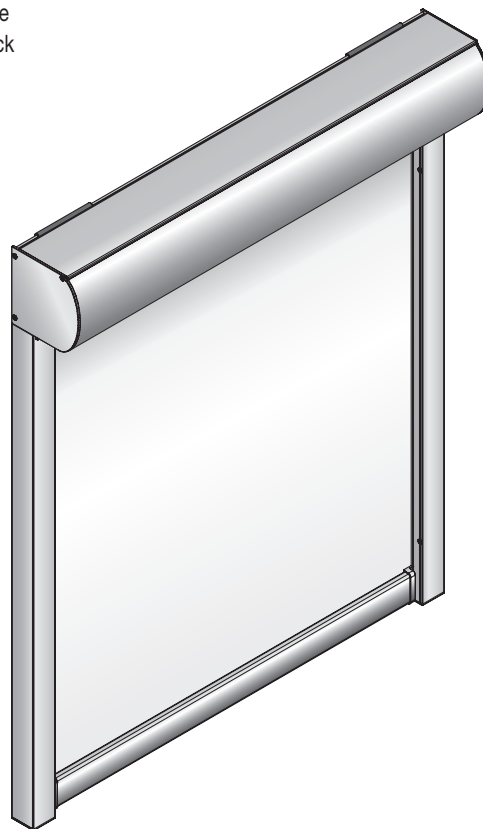

Available Sizes

WIDTH:	2'	4'	6'	8'	10'	12'	14'	16'	18'	20'	22'	24'	26'
HEIGHT	2'												
4'													
6'													
8'													
10'													
12'													
14'													
16'													
18'													

PROJECT: _____

ARCHITECT: _____

CONTRACTOR: _____

SUPPLIER: _____

DATE: _____ REVISED: _____



Draper, Inc. | 411 S. Pearl St. Spiceland, IN 47385
draperinc.com | 765.987.7999 | 800.238.7999

© 2018 All Rights Reserved | FORM: FlexShadeZipXL_Sub18-R

Specifications

Motorized Operator:

ALTUS RTS 120V AC RADIO TECHNOLOGY ELECTRIC OPERATOR: Drive unit inside roller, 3-wire, instantly reversible, lifetime lubricated. Right hand motor location standard. Left hand available. Adjustable limit switches, thermal overload protector and electric brake. Operates on 110-120V AC 1HP 60 HZ current. Draws 1.6 Amps.

MAESTRIA RTS 120V AC OBJECT DETECTION ELECTRIC OPERATOR: Drive unit inside roller, 3-wire, instantly reversible, lifetime lubricated. Right hand motor location standard. Left hand available. Adjustable limit switches, thermal overload protector and electric brake. Operates on 110-120V AC 1HP 60 HZ current. Draws 1.6 Amps.

ALTUS 120V AC ELECTRIC OPERATOR: Drive unit inside roller, 4-wire, instantly reversible, lifetime lubricated. Right hand motor location standard. Left hand available. Adjustable limit switches, thermal overload protector and electric brake. Operates on 110-120V AC 1HP 60 HZ current. Draws 1.6 Amps.

Hardware:

ROLLERS: 2.364" (60 mm) dia. Aluminum with 0.049" (1.245 mm) wall; or 3.07" (78 mm) dia. Steel with 0.049" (1.245 mm) wall; with galvalum coating.

HEADBOX: Two-piece extruded aluminum headbox shall be 5" (127 mm) tall x 5" (127 mm) deep. Silver, black, white, ivory, sand or bronze powder coat finish.

FABRIC: Fabric panel to incorporate pockets at the top and bottom to allow connection to the roller tube and to the hembar. 'Zip' detail welded to the two vertical sides of the fabric panel.

HEM BAR: Aluminum, with steel weight to reduce fabric movement. Color to match headbox.

SIDE CHANNELS/FABRIC RETENTION SYSTEM: Side channels to be extruded aluminum and incorporate plastic inner channels. Plastic inner channels to be held inside the extrusion by means of cushioning pads that also dampen the movement of the fabric panel under wind load. 'Zip' details on the edges of the fabric panel to run in the inner channels to retain the fabric in place.

PATENT INFORMATION: available at www.draperinc.com/legal/patents

DOWNLOADABLE 3-PART SPECIFICATIONS: available at www.draperinc.com.

Please note: Dimensions of rollers, operators and hardware at manufacturer's discretion.

Hardware Options

Headbox Options

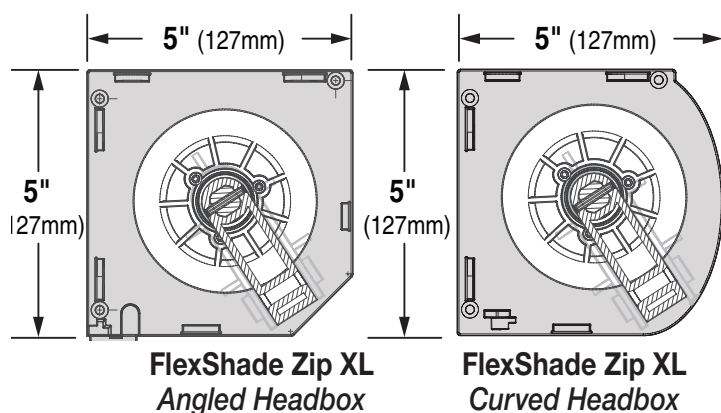

Side Channel Dimensions

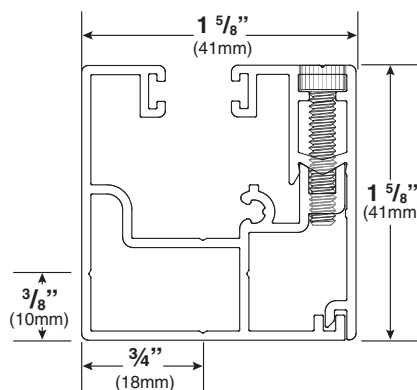

Hembar Dimensions

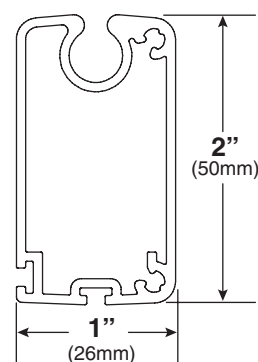

Zip XL Ceiling Mounting Bracket

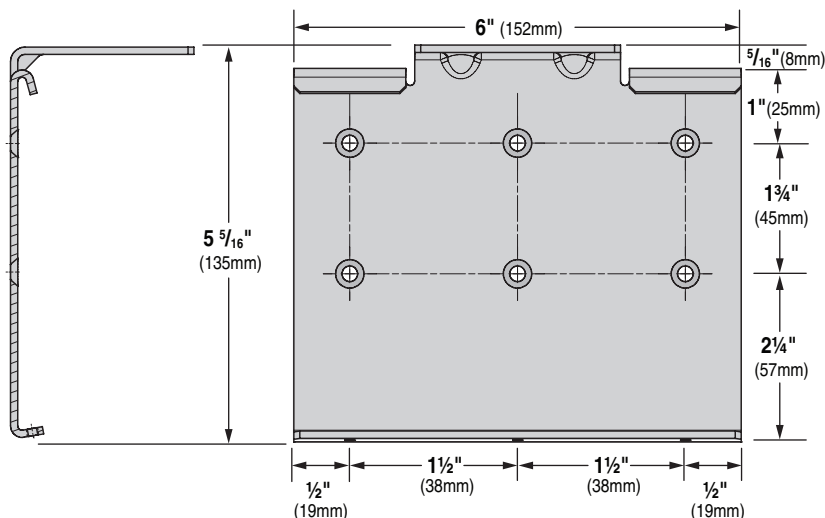

Zip XL Wall Mounting Bracket

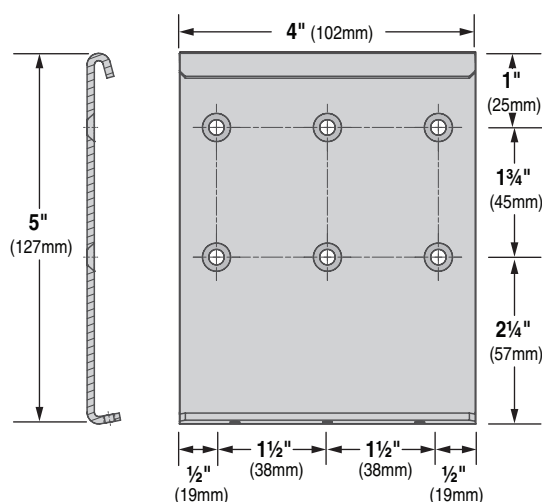

NOTE: Mounting brackets attach to surface with #10 Flat Head Screw

FlexShade® Zip XL

Dimensions

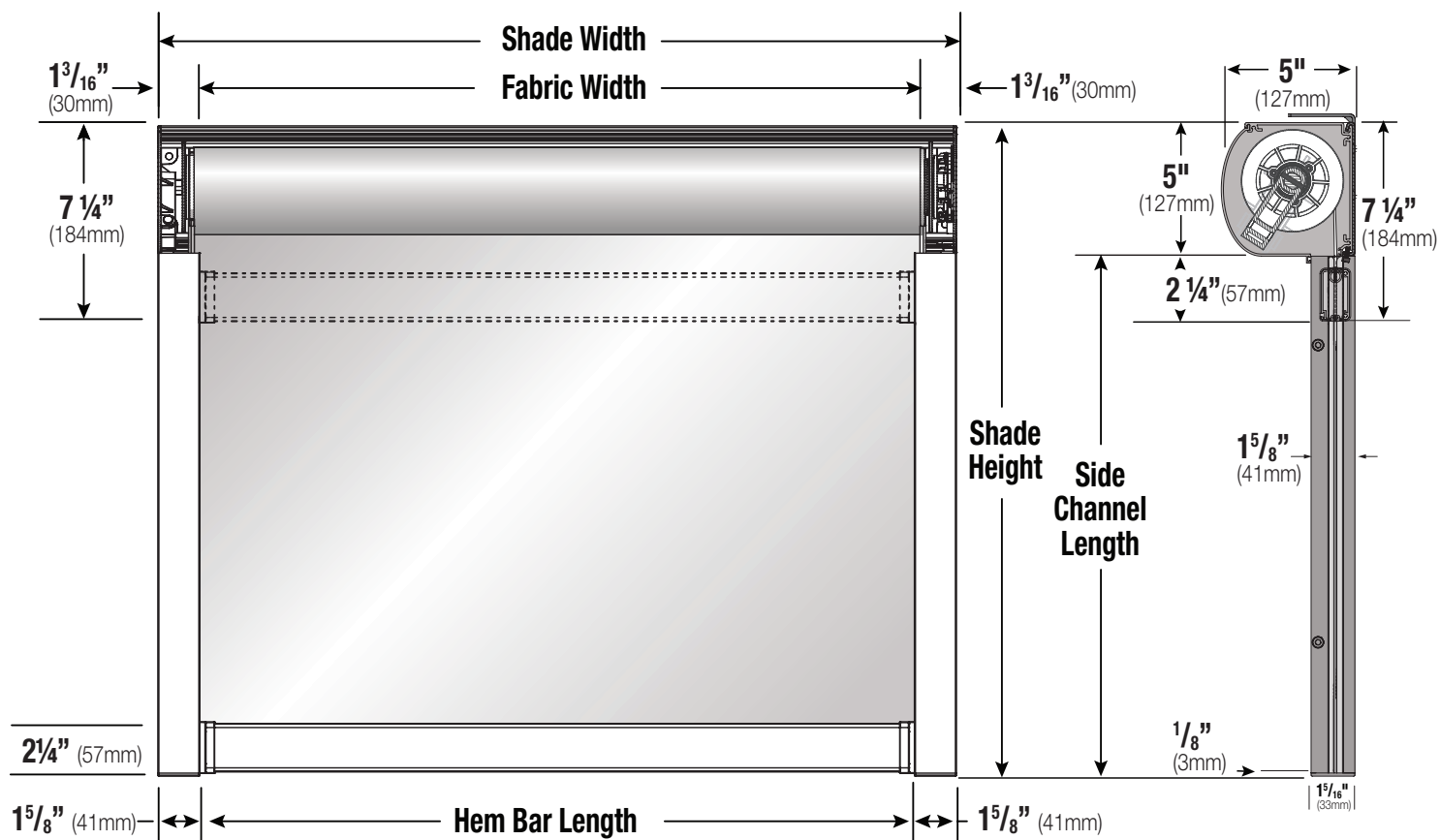

Angled Headbox (Ceiling Mount shown)

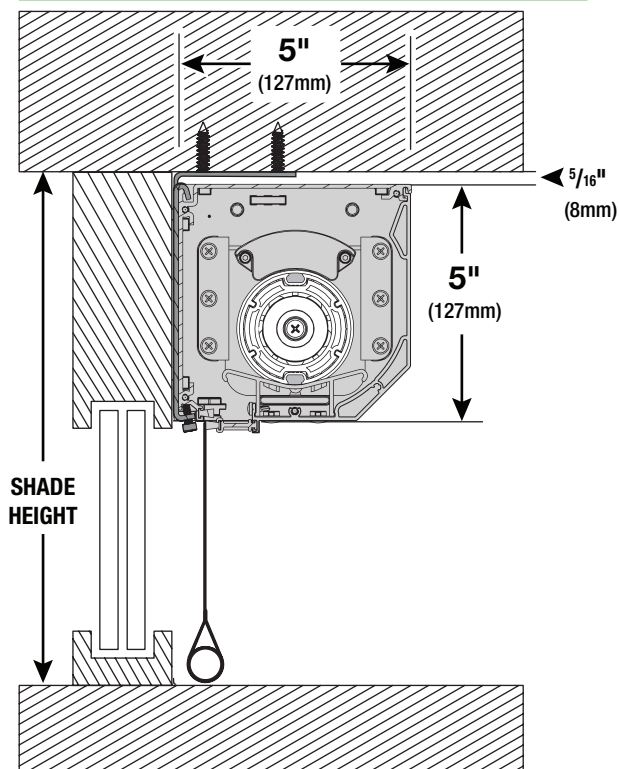

Curved Headbox (Surface/Wall Mount Shown)

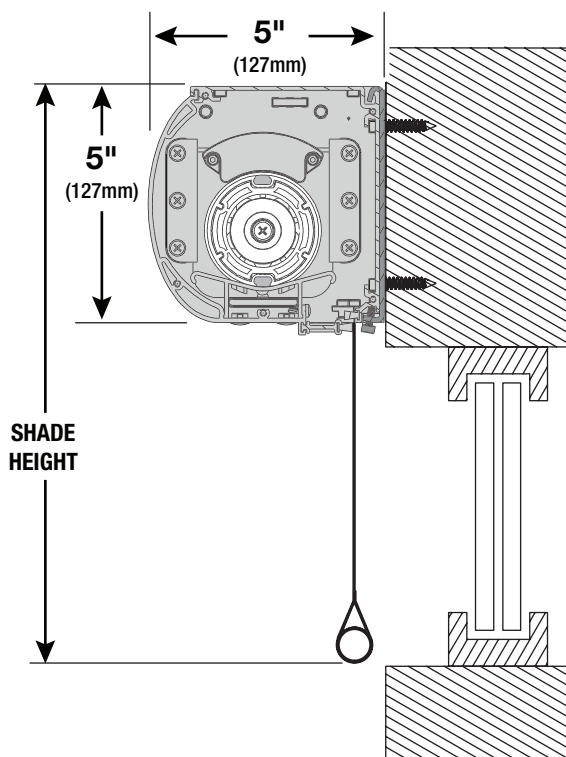

Wiring Diagrams

Controls & System Overview

Sonesse RTS 120VAC Motors

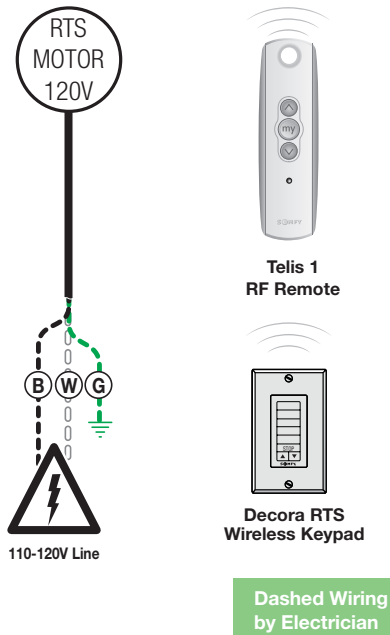

Controls & System Overview

Sonesse 120VAC Motors

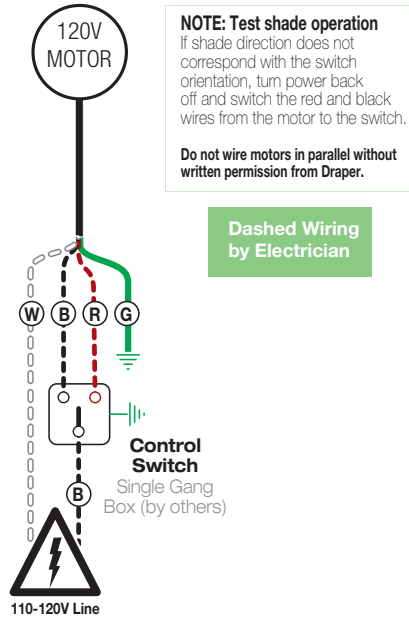

NOTE: Test shade operation
If shade direction does not correspond with the switch orientation, turn power back off and switch the red and black wires from the motor to the switch.

Do not wire motors in parallel without written permission from Draper.

Dashed Wiring
by Electrician

Please Note: Test shade operation. If shade direction does not correspond with the switch orientation, turn power back off and switch the red and black wires from the motor to the switch.